

## Sea Harrier N94422 Emergency Extraction Guide



## Step One: FIRE - - EXTINGUISH

If the engine is still running, DROWN with water/foam applied to the ENGINE INTAKE, or the FIRE ACCESS on upper fuselage

The FORWARD Fire Access Panels will channel water or agent to the FRONT part of the engine compartment.



The AFT Fire Access Panel will funnel agent to the REAR of the engine compartment.



## Step Two: CANOPY - - OPEN

IF UPRIGHT, use the NORMAL CANOPY OPENING

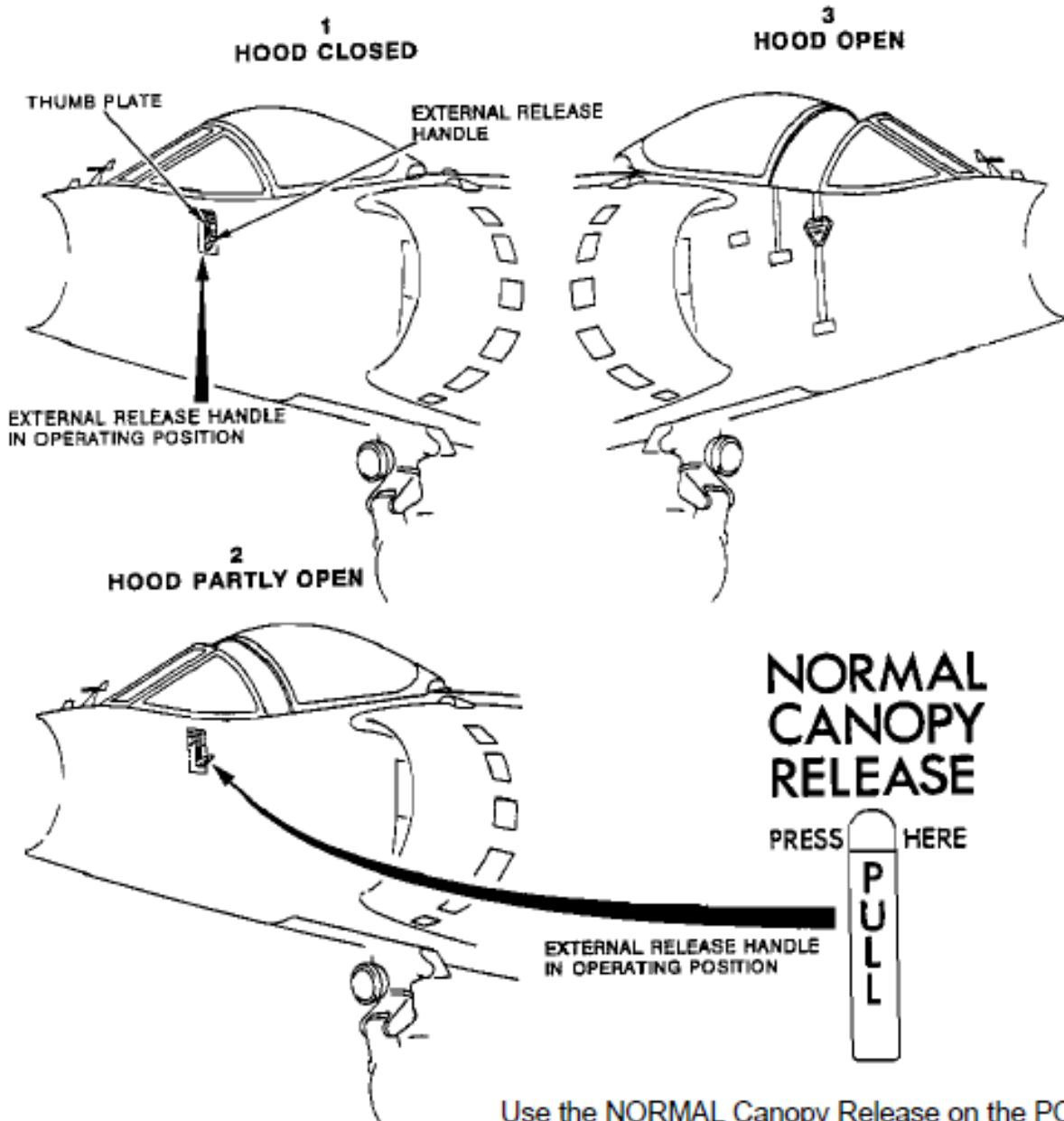

Use the NORMAL Canopy Release on the PORT SIDE unless the airplane is on FIRE. The NORMAL release raises latching hooks, ONE ON EACH SIDE, to allow the canopy to slide rearward and open. If ONE OF THE LATCHES does not release, it can be raised by using a screw driver or other bladed tool. The canopy should then slide open.

ALTERNATE EMERGENCY MEANS

THE CANOPY SHOULD FIRST BE OPENED BY THE NORMAL RELEASE. However, if the latches (one on each side) fail to release, use a FLAT BLADE TOOL to gently lift the latches to release the canopy. Attempt to NOT damage the canopy seal, if possible.

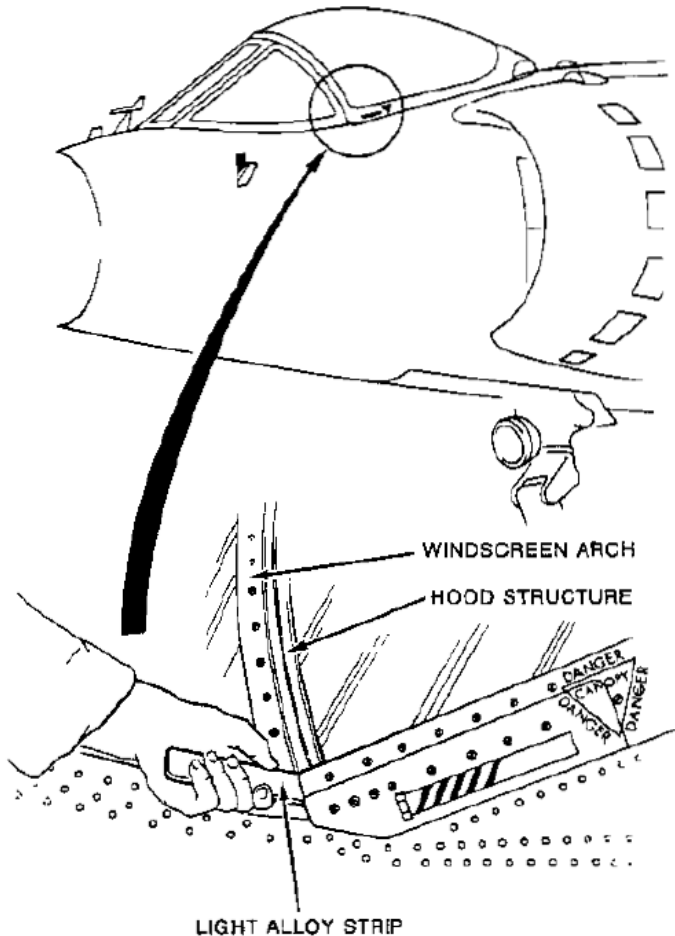

\*\*\* ON BOTH LEFT AND RIGHT SIDE \*\*\*

IF INVERTED ON THE GROUND, use an axe to break the transparency.



NOTE: **THE EMERGENCY CANOPY DETONATION IS INOP.**

THERE ARE NO EXPLOSIVES IN THE CANOPY TRANSPARENCY OR THE DETONATOR.

### Step Three: EJECTION SEAT - - MAKE MECHANICALLY SAFE

BY RAISING THE YELLOW/BLACK HANDLE ON THE RIGHT SIDE OF THE SEAT TO THE HORIZONTAL POSITION.

IT WILL LOCK IN THE SAFE POSITION.

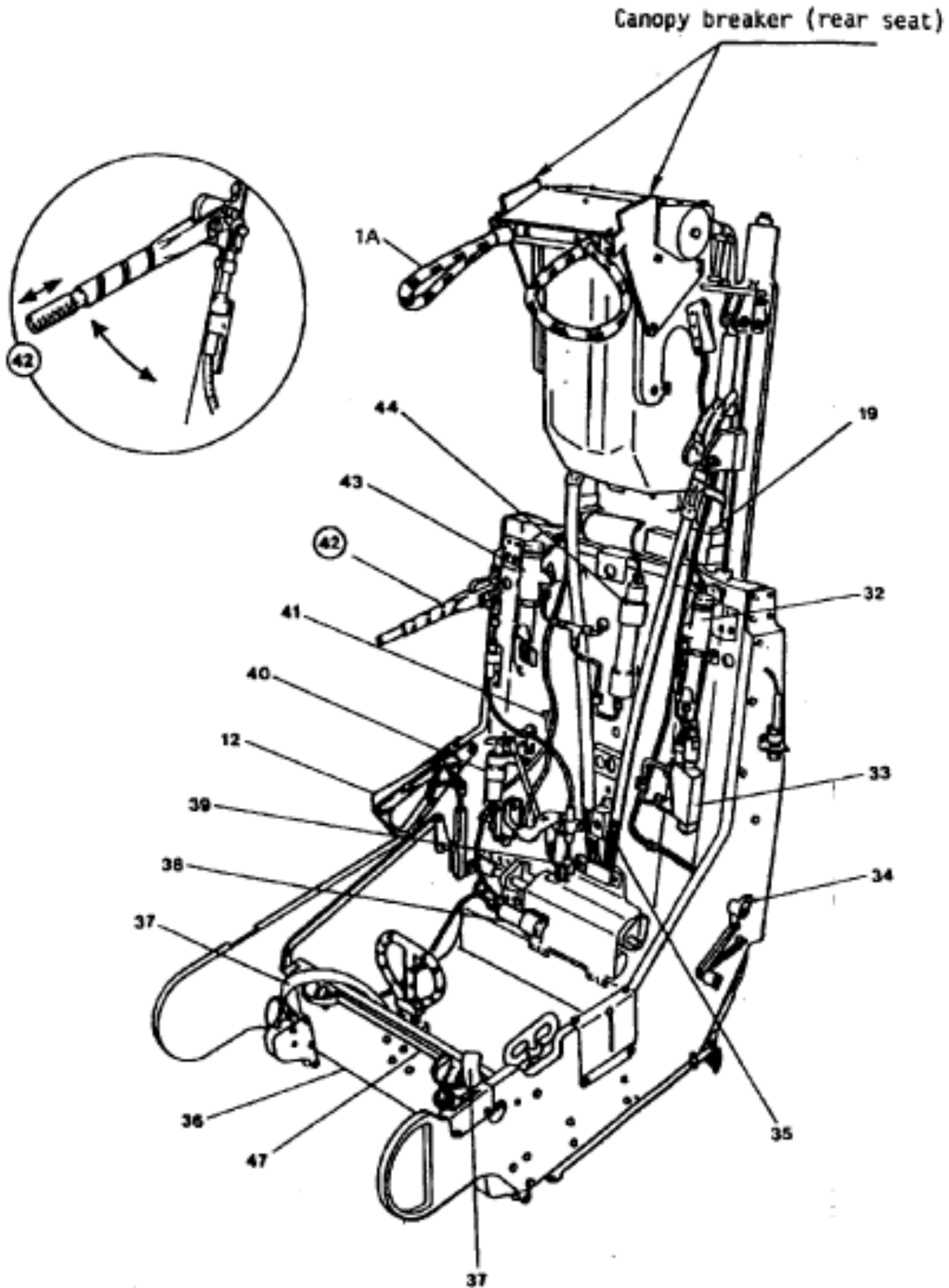

# Step Four: BATTERY MASTER SWITCHES - - OFF

(center position of switch)

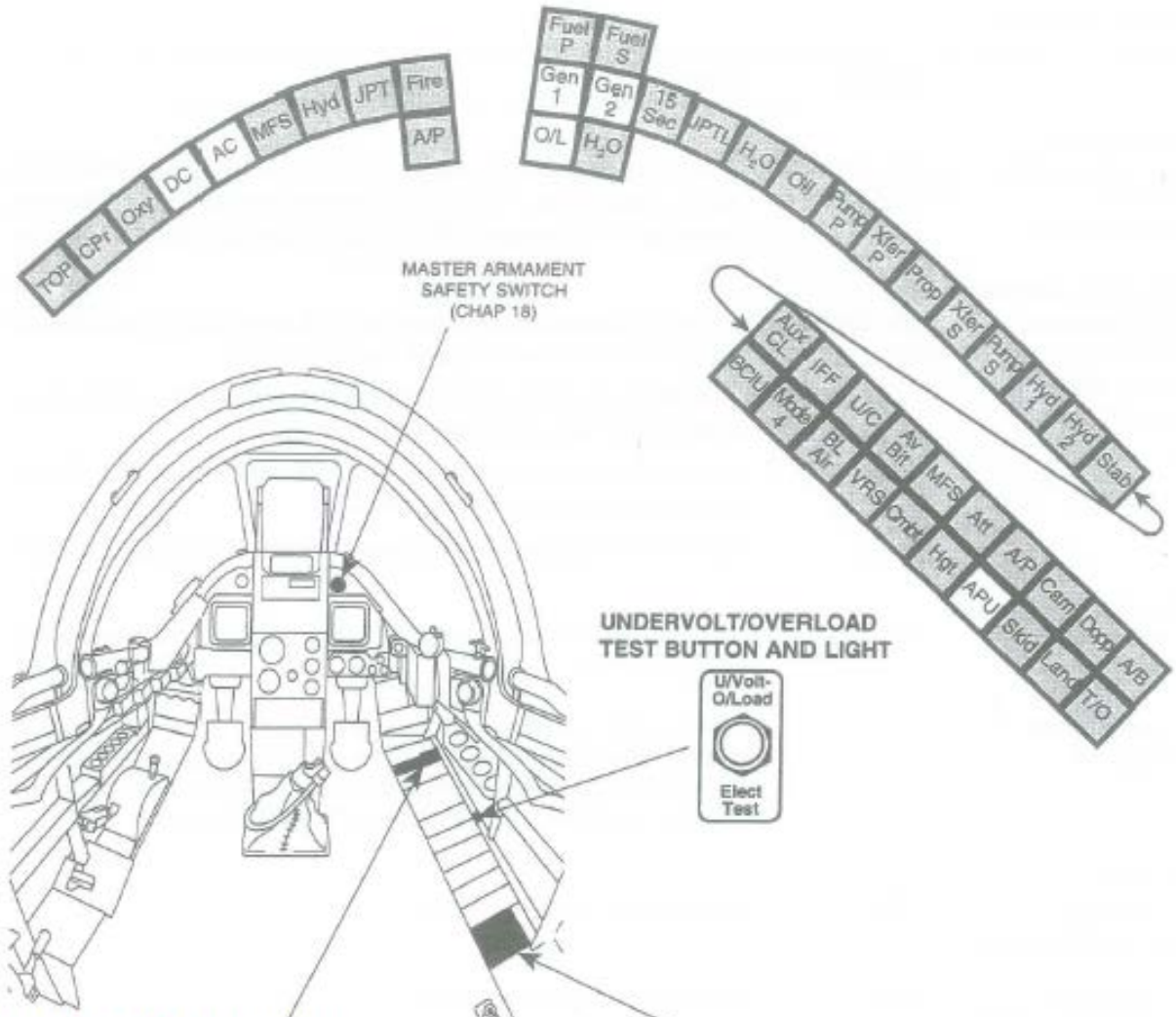

ONCE THE SEAT IS SAFE.....

Turn off the batteries on the upper right control panel. There are TWO batteries and BOTH need to be OFF

need to be OFF

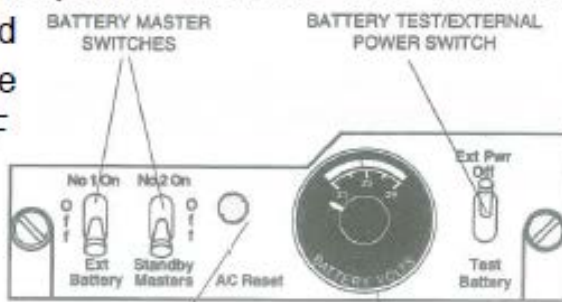

AC RESET BUTTON VOLTMETER

ELECTRICAL PANEL

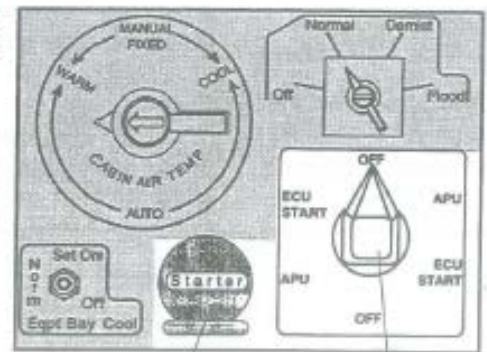

ENGINE & APU STARTER BUTTON AND COVER FLAP

GTS MODE SELECTOR



**Step Five: FUEL SHUTOFF** - - on the LEFT REAR OF COCKPIT, raise the FUEL SHUTOFF (Low Pressure Fuel COCK #38 )

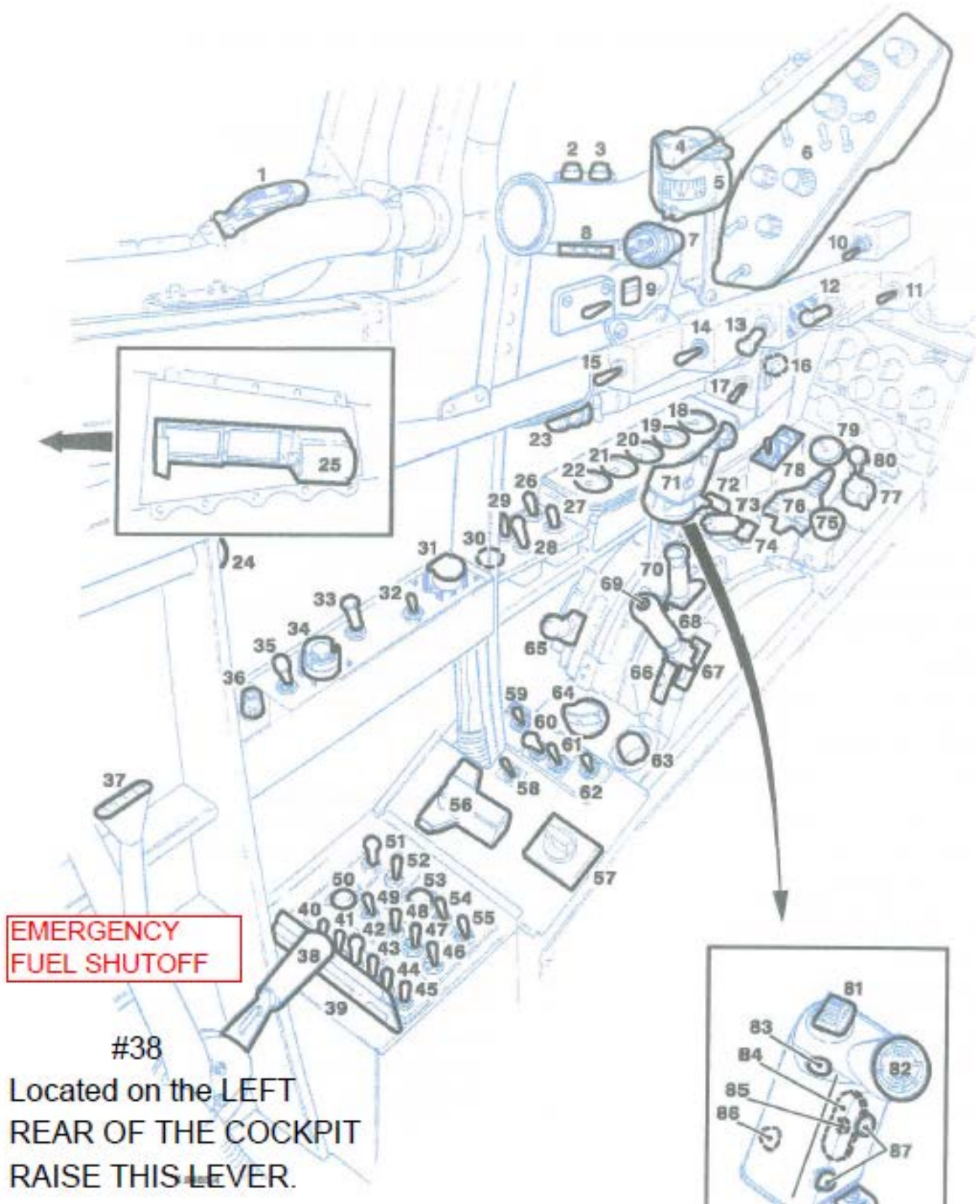

**Step Six: RELEASE PILOT FROM THE HARNESS AND THE LEG restraints.**

AP101B-4802-1A

ONCE THE SEAT IS SAFE.....The BATTERIES OFF.....  
The EMERGENCY FUEL is shutoff,  
RELEASE THE PILOT FROM THE HARNESS.

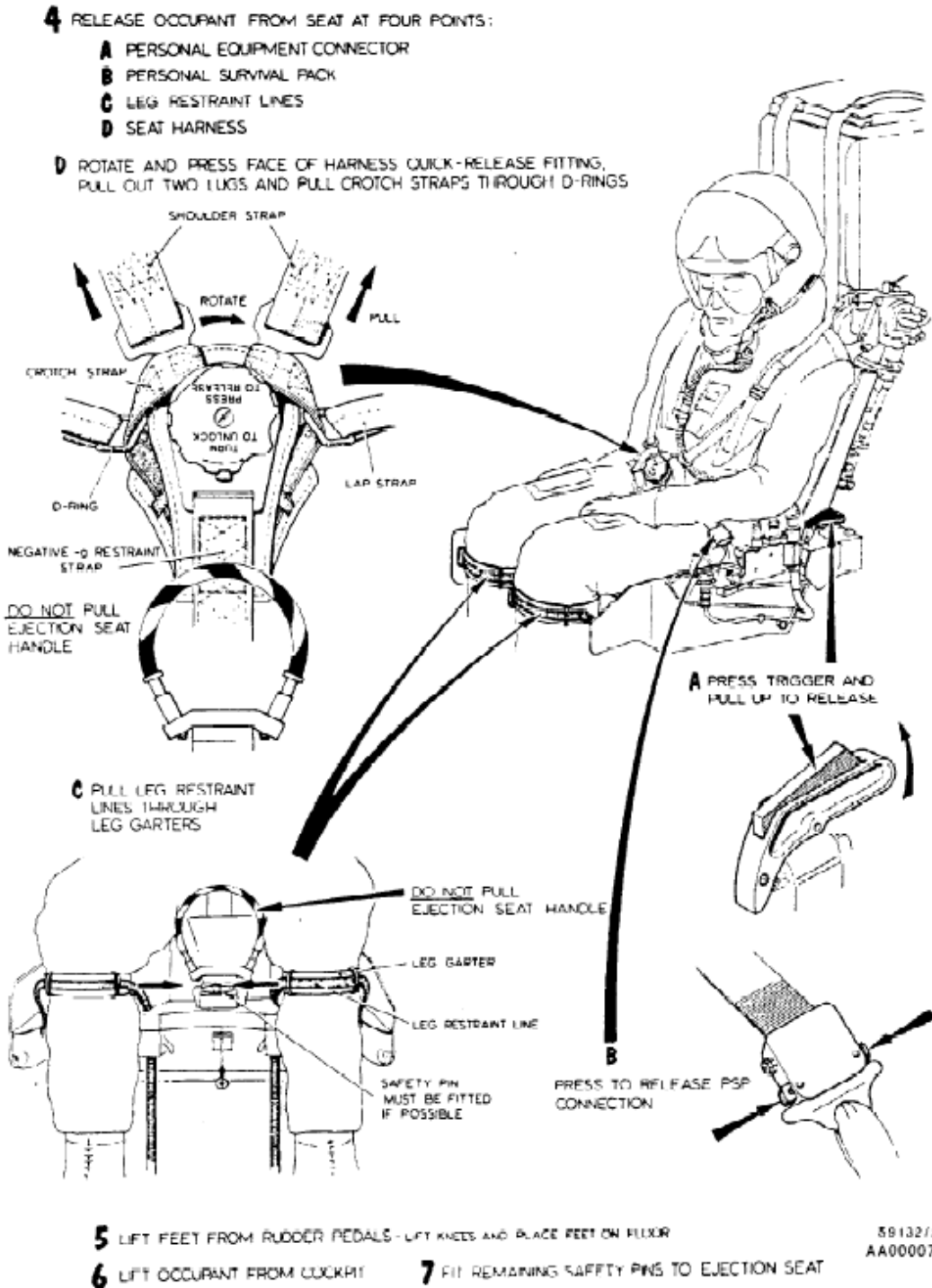

**Fig.1** Actions required to render seat safe and to release pilot (sheet 2)  
(Occupant release sequence amended)



## Sea Harrier Points of Contact

**Aircraft Type:** Sea Harrier, FA.2

**Registration:** N94422 Experimental / Exhibition

**Pilots:** Arthur L. Nalls, Jr. or Joseph T. Anderson

**Emergency Contact:** Patricia L. Hatfield-Nalls (wife of Arthur Nalls, Jr.)

**Emergency Number:** 202-271-1476 cell or 410-326-4905 home

**Date:** AUGUST 2015

